

## Thiele Integral XJX PBOM Sealer

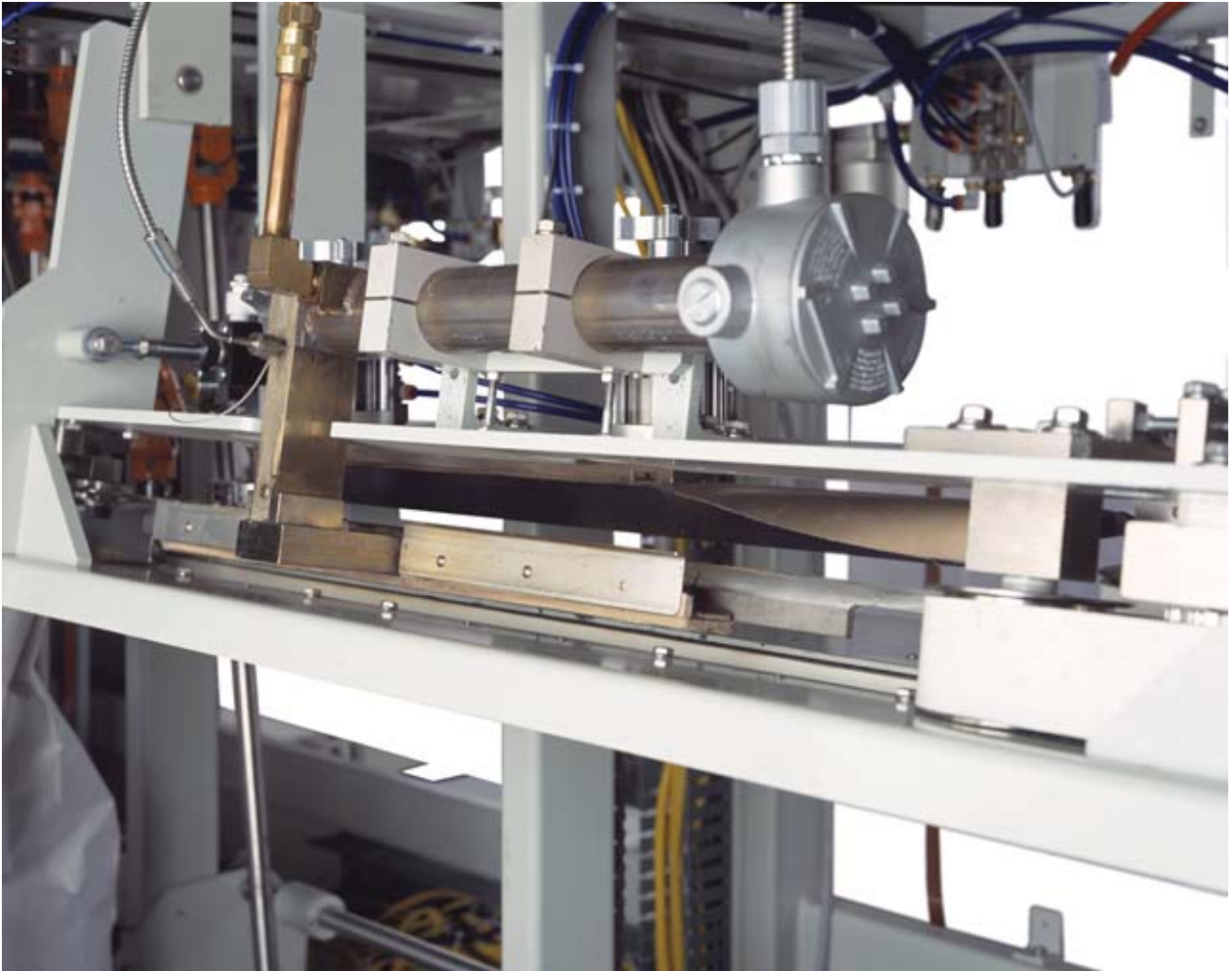

### Features

- Helps ensure small footprint for machine by eliminating external sealer
- Eliminates bag jam that often occurs with handoffs to external sealing products
- Servo-driven top and bottom belt system for positive bag control
- Advanced parameter electronics adjustable by recipe through HMI
- Easy clean out - simply press a clean-out pushbutton for easy access
- Easy, tool-less replacement of critical parts - remove and replace the folder blade and heater nozzle in seconds

# Thiele Integral XJX PBOM Sealer

The XJX Integral Bag Sealer offers unprecedented speed and reliability. At speeds in excess of 150 feet per minute, you're guaranteed to increase your productivity.

The Integral XJX PBOM Sealer is integrated directly into the exit station of either Thiele's OmniStar Bagger or UltraStar Bagger.

This innovation lets you seal pre-glued paper and multi-wall paper bags at speeds of over 30 bags per minute.

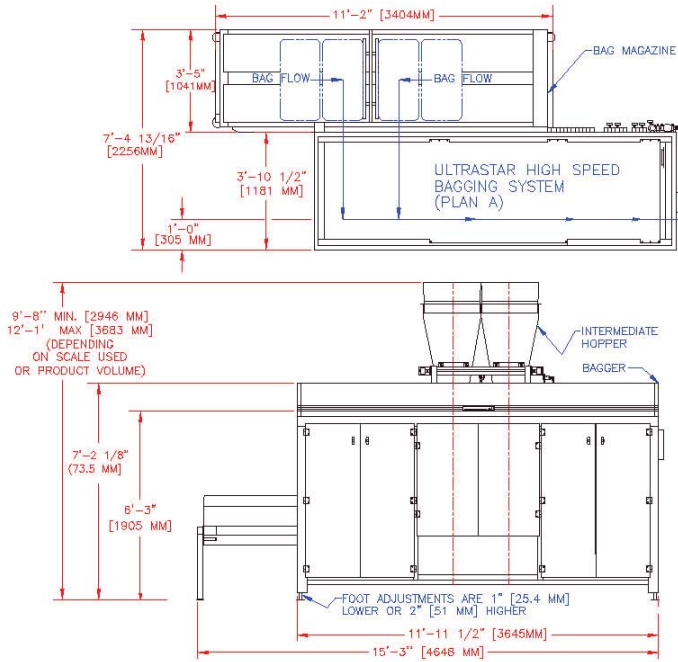

UltraStar Layout

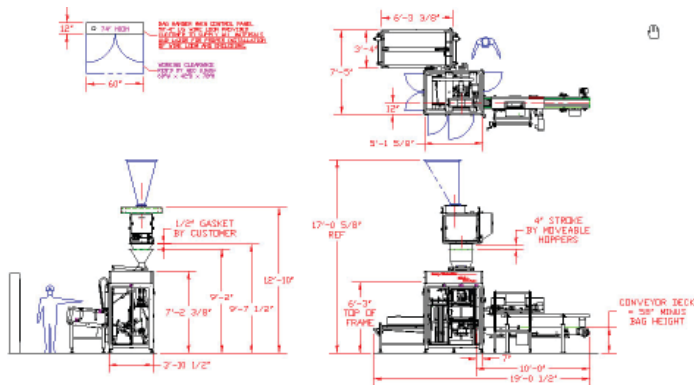

OmniStar Layout

## Specifications

### Production Speed

Up to 20 bags per minute with OmniStar  
Up to 35 bags per minute with UltraStar

### Dimensions

Length	4 ft. (1219.2 mm)
Width	10 in. (254 mm)
Height	10 in. (254 mm)

### Shipping Weight

Shipped installed on bagger

### Electrical Requirements

Power supplied by bagger

### Air Requirements

Air supplied by bagger

Hayssen | Hudson-Sharp | Rose Foregrove | Sandiacre | Schib | Simonato | SYMACH | Thiele