

Thiele AutoTrim[®] 7116 Chemical Packer



Features

- Completely automatic system
- In-line operation to maintain bag top control
- Integrated, two-stage feed that ensures accuracies and maintains speed
- Positive auger control that handles a variety of products while minimizing dust
- Tube-in-bag filling provides product and dust control
- Automatic fill time adjustments and immediate data
- Removable feeder
- Corrosion resistant

Thiele 7116 AutoTrim[®] Chemical Packer

The Thiele Series 7116 Chemical Packer is a completely automatic, integrated bag packaging system that offers bag feeding, registration and positive bag opening, dual auger product handling and bulk filling, vibratory top-off station, and positive bag control throughout the system.

The chemical packer features a feeder section that is designed to handle a variety of products. The dual bulk and dribble auger feeder system is capable of feeding many hard-to-handle products.

Key Benefits

- No manual labor required
- Better dust control
- Increased speed
- Enhanced accuracy
- Automatic bag registration
- Integrated bag settler mechanism

Additional Features

- 304 stainless steel product contact surfaces

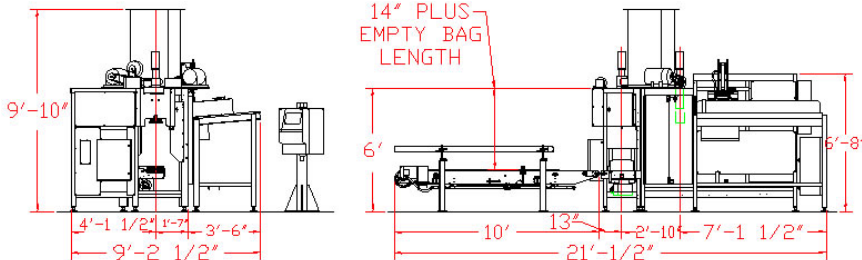
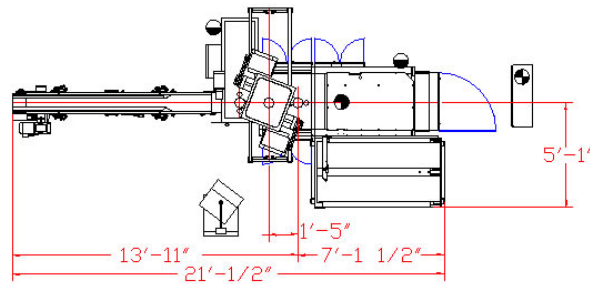

Specifications

Production Speed

Up to 10 bags per minute

Power Requirements

Input Power	240/480 V, 1 phase, 60 Hz
Control Circuit	115 volts provided through control transformer
Maximum Draw	240/480 Volts

Air Requirements

Operating Pressure	80 psi (5.4 Atm)
Line Pressure	90 psi (6.1 Atm)
Free Air Per Cycle	1.5 cubic ft.

Shipping Weight

Approximately 7,000 lbs. (3,175 kg)

Hayssen | Hudson-Sharp | Rose Foregrove | Sandiacre | Schib | Sionato | SYMACH | Thiele